

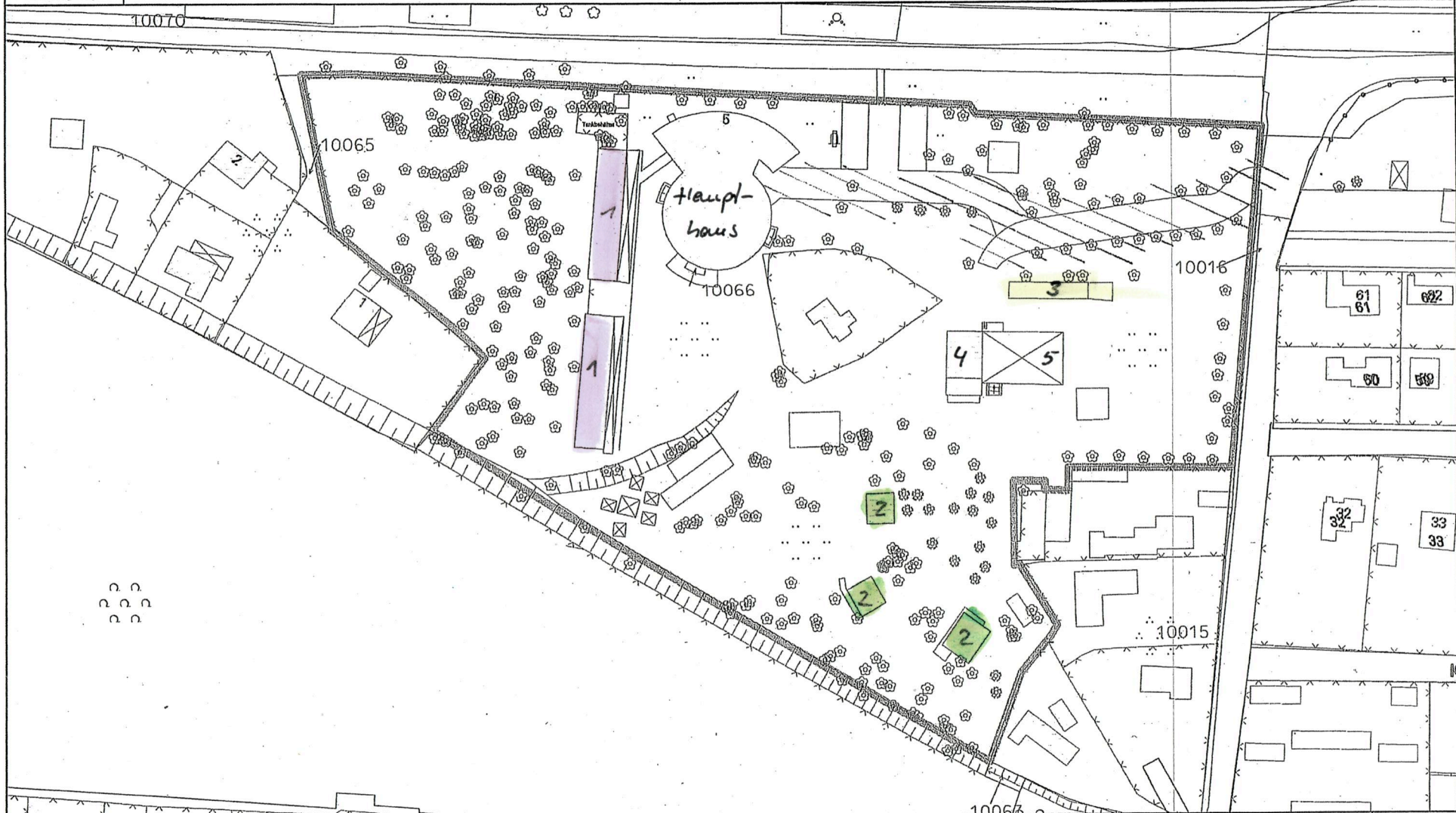

Landeshauptstadt Magdeburg

Eb KGm

Datum: 09.04.2008
Bearbeiter: Frau Siemann



M 1 : 1000

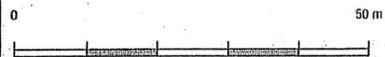

Am Mittellandkanal 5
IJFZ Barleber See

zu sanierende
Zuwegung

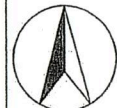

1 - Bungalowzeile
2 - Einzelbungalow

3 - Baracke
4 - Backsteinbau
5 - Terrasse